



UNIVERSAL SWITCH REPLACEMENT KIT

a xylem brand

WARNING!



**Turn off power before servicing pump.
Open faucets to relieve system pressure.**

SWITCH REPLACEMENT INSTRUCTIONS

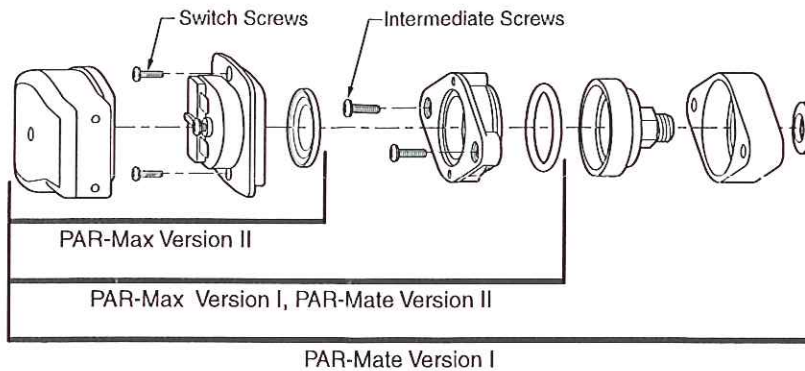

	PAR-Mate Version I	44010 Series
	PAR-Mate Version II	44010 Series
	PAR-Max Version I	30XXX Series
	PAR-Max Version II	31XXX Series

Turn off power before servicing pump. Open faucets to relieve system pressure. If pump is located below the supply tank, insure that the supply tank valve is closed to prevent water leakage during service.

Disconnect wires from terminals and remove old pressure switch from pump. Determine pump model and vintage from the table and diagram above. Re-assemble parts for your model in sequence shown.

Tighten intermediate screws (if used) to 15 inch-pounds of torque. Tighten switch screws to 7 inch-pounds of torque. Replace terminals with new terminals supplied in this kit.

Note: The screw that is pre-mounted on the face of the switch housing is the pressure adjustment screw. This is

JABSCO DAMPENER NOTE: (Applies To models 36800-Series, 36950-Series, 36970-Series and 37215-Series only)

Note: When replacing the pressure switch on your Jabsco pump, it is important to check the pulsation dampener for possible collapse or deterioration. This can be easily done by first turning off power to the pump; then bleeding your water system by opening the faucets. Next, disconnect the pump from its installation and remove the base plate of the pump. The pulsation dampener is the large rubber chamber located directly under the base plate. If the dampener is soft or its shape is distorted or cut, it should be replaced. Insuring that the dampener is firm and resilient will minimize pump cycling and provide the best performance and life.

a factory pre-set switch, DO NOT ADJUST. Possible damage to the piping, components in the system or injury to humans or animals is possible. Adjustments other than the one made by the factory voids the warranty.

Extremly on the plastic switch cover there is screw hole to attach the cover to the switch once the switch is installed on the pump housing. A separate screw is provided for this installation. Older types of Jabsco switches either did not use a cover or had a rubber boot.

Close all faucets. Turn power on to pump. Open faucet to bleed trapped air from system. When bubbles stop, close faucet and confirm that pump turns off automatically. Check for leaks and proper operation.

THE PRODUCTS DESCRIBED HEREIN ARE SUBJECT TO THE JABSCO ONE-YEAR LIMITED WARRANTY, WHICH IS AVAILABLE FOR YOUR INSPECTION UPON REQUEST.

www.xylemflowcontrol.com

Jabsco, 100 Cummings Center, Ste. 535-N, Beverly, MA 01915
Tel: +1 978 261 0440 Fax: +1 978 283 2619

USA

Jabsco, Bingley Road, Hoddesdon, Hertfordshire, EN11 0BU
Tel: +44 (0) 1992 450 145 Fax: +44 (0) 1992 467 132

UK

NHK Jabsco Co Ltd, 3-21-10, Shin - Yokohama Kohoku-ku, Yokohama 222
Tel: +81 (0) 45 475 8906 Fax: +81 (0) 45 475 8908

JAPAN

Jabsco GmbH, Oststraße 28, 22844 Norderstedt
Tel: +49 (0) 40 53 53 73 0 Fax: +49 (0) 49 53 53 73 11

GERMANY

Jabsco Italia, s.r.l. Via Tommaso, 6, 20059 Vimercate, Milano
Tel: +39 039 665 2323 Fax: +39 039 666 307

ITALY



a xylem brand